

STATE OF NORTH CAROLINA
DIVISION OF HIGHWAYS

MADISON COUNTY

LOCATION: NC 208 FROM INTERSECTION OF US 25-70
TO INTERSECTION NC 212

TYPE OF WORK: PAVING, WIDENING, GUARDRAIL,
AND PIPE REPLACEMENT

| STATE | STATE PROJECT REFERENCE NO. | SHEET NO. | TOTAL SHEETS |
|-----------------|-----------------------------|-------------|--------------|
| N.C. | DM00242 | 1 | |
| STATE PROJ. NO. | F.A. PROJ. NO. | DESCRIPTION | |
| 47805 | | CONST | |
| | | | |
| | | | |
| | | | |
| | | | |
| | | | |

WBS ELEMENT: 47805

CONTRACT: DM00242

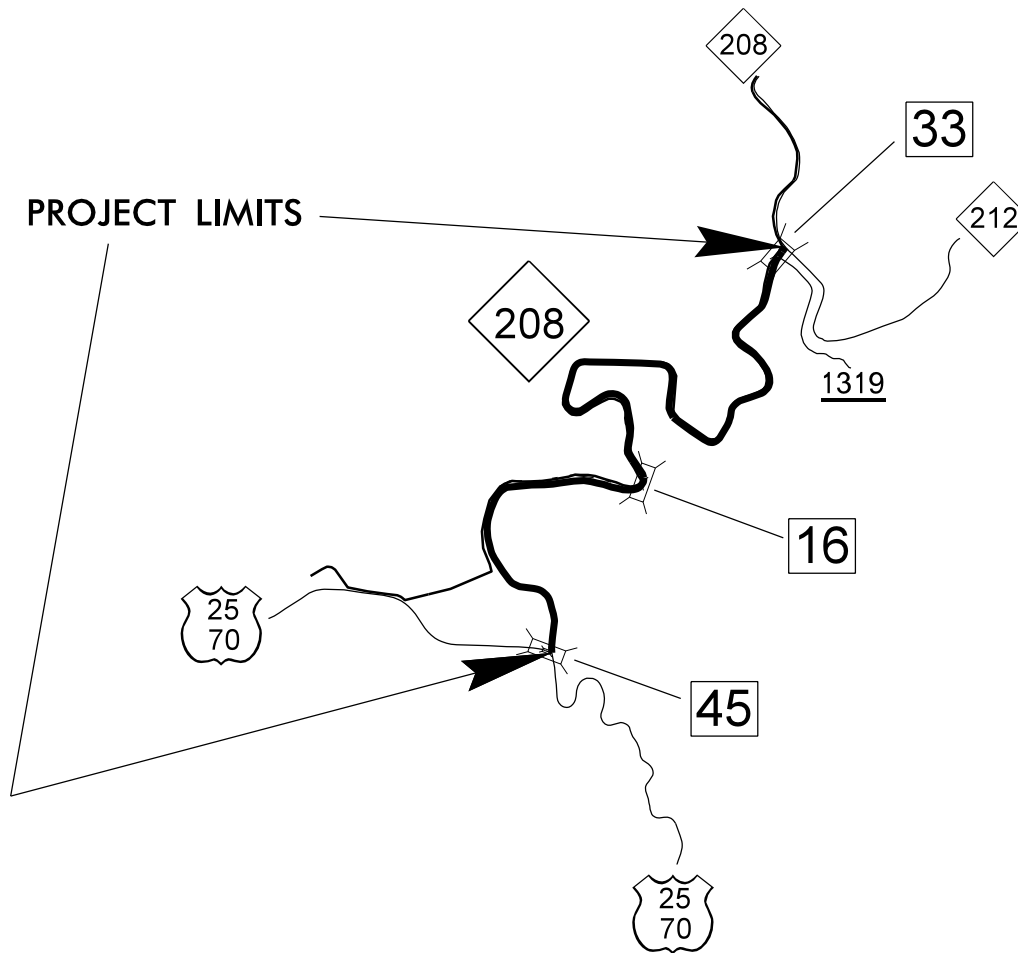

PROJECT NOTES:

ALL DATA PROVIDED IS FOR ESTIMATING PURPOSES ONLY.
NO SURVEY DATA IS AVAILABLE FOR THIS PROJECT. ALL
MEASUREMENTS ARE NON-SURVEY GRADE FIELD MEASUREMENTS.

NO SUBSURFACE PLANS ARE AVAILABLE ON THIS PROJECT.
THE CONTRACTOR SHOULD MAKE THEIR OWN INVESTIGATION
AS TO THE SUBSURFACE CONDITIONS.

PIPE LOCATIONS SHOWN ON PLANS ARE FOR REPRESENTATION
ONLY. SEE PIPE SUMMARY FOR STATION LOCATIONS AND
LENGTHS.

PROJECT LENGTH

LENGTH ROADWAY PROJECT = 3.529 MILES

TOTAL LENGTH PROJECT = 3.529 MILES

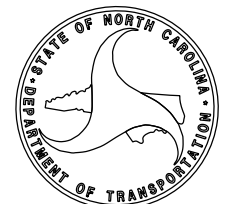

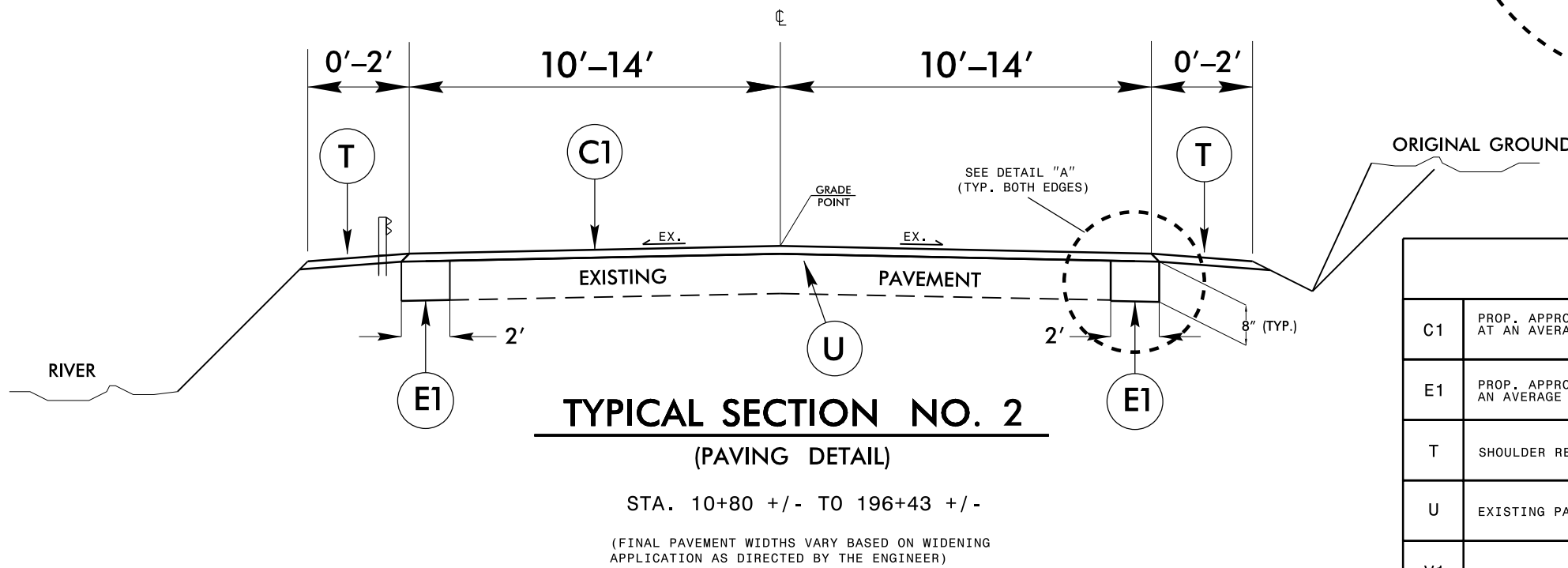
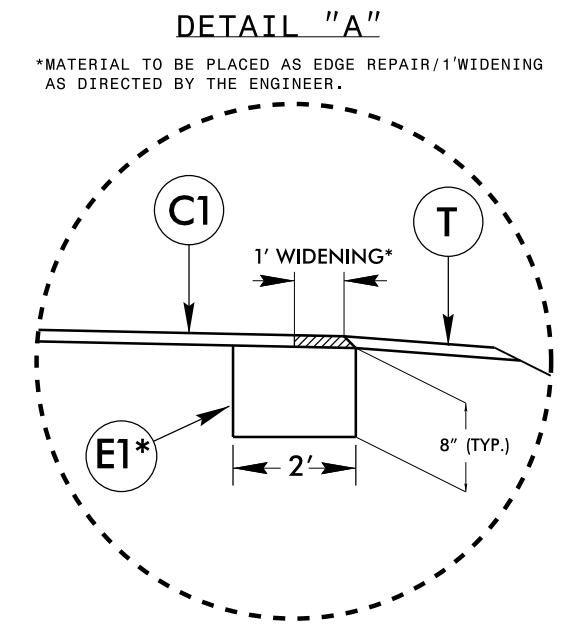
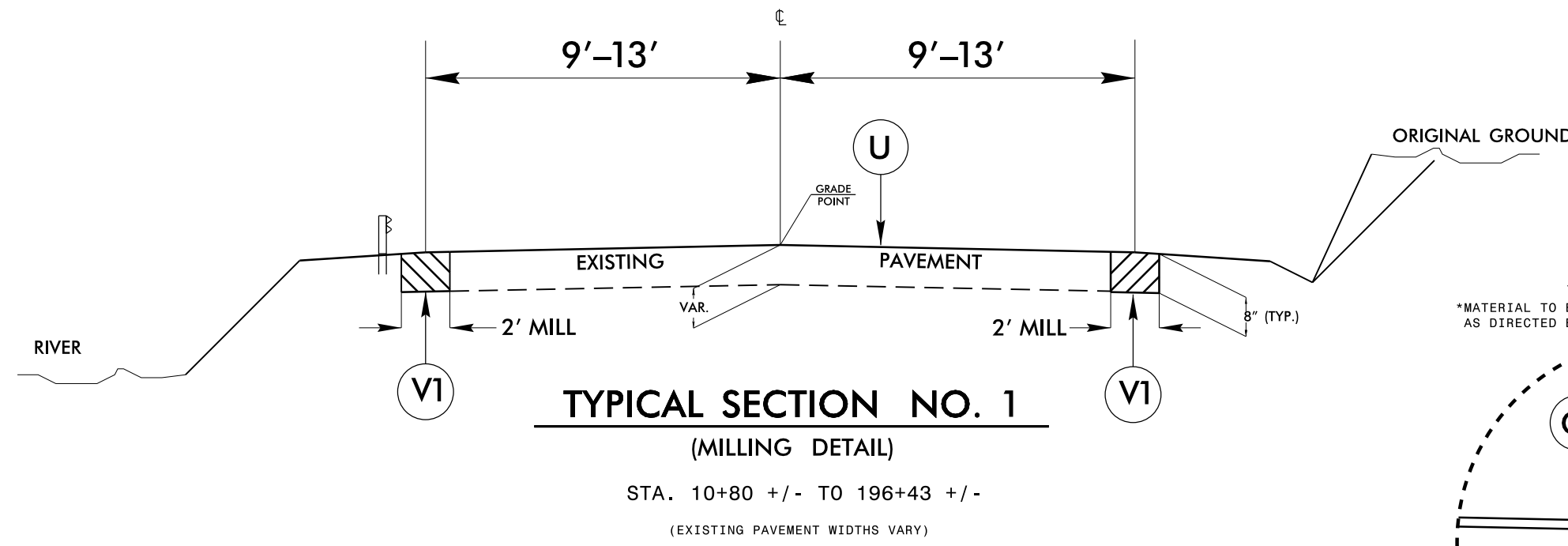

| PAVEMENT SCHEDULE | |
|-------------------|---|
| C1 | PROP. APPROX. 2" ASPHALT CONCRETE SURFACE COURSE, TYPE S9.5C, AT AN AVERAGE RATE OF 224 LBS. PER SQ. YD. |
| E1 | PROP. APPROX. 8" ASPHALT CONCRETE BASE COURSE, TYPE B25.0C, AT AN AVERAGE RATE OF 456 LBS. PER SQ. YD. IN EACH OF TWO LAYERS. |
| T | SHOULDER RECONSTRUCTION |
| U | EXISTING PAVEMENT. |
| V1 | MILLING ASPHALT PAVEMENT, 8" DEPTH |
| V2 | MILLING ASPHALT PAVEMENT, 2" DEPTH |
| V3 | INCIDENTAL MILLING |

NOTE: PAVEMENT EDGE SLOPES ARE 1:1 UNLESS SHOWN OTHERWISE.

| | |
|---|------------------------|
| PROJECT REFERENCE NO. DM00242 | SHEET NO. 2B |
| RW SHEET NO. | |
| ROADWAY DESIGN ENGINEER | HYDRAULICS ENGINEER |

PIPE BACKFILL DETAIL

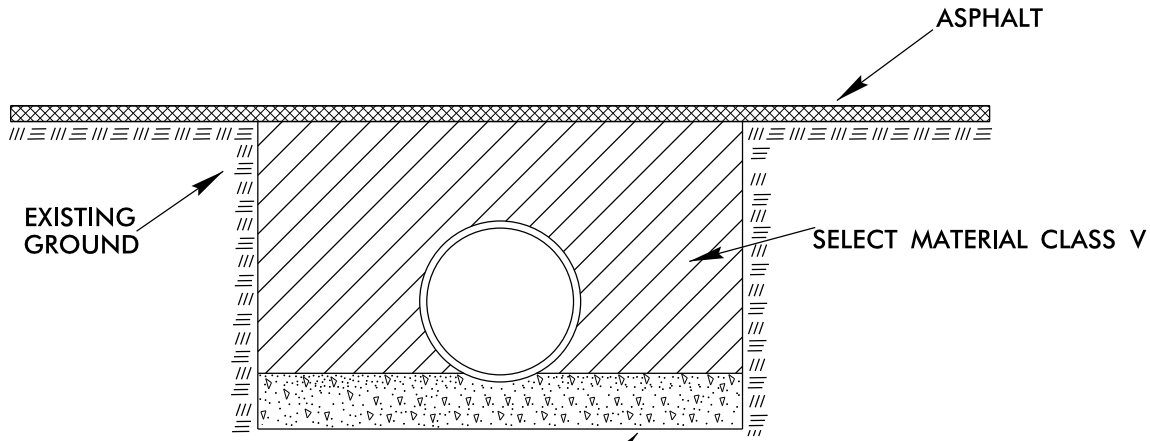

SELECT MATERIAL CLASS III OR CLASS II, TYPE 1 FOR PIPE BEDDING.

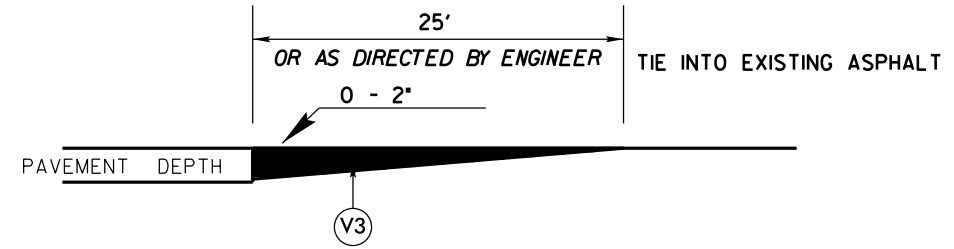

DETAIL TO TIE INTO EXIST PAVEMENT

THE CONTRACTOR'S ATTENTION IS DIRECTED TO THE FACT THAT HE WILL BE REQUIRED TO MILL THE EXISTING ASPHALT PAVEMENT TO ENSURE A PROPER TIE-IN WITH THE EXISTING SURFACE AT THE BEGINNING, END AND Y LINES OF EACH MAP TO BE RESURFACED WITH ASPHALT CONC SURFACE COURSE, TYPE S9.5C THIS WILL BE PAID FOR AS INCIDENTAL MILLING.

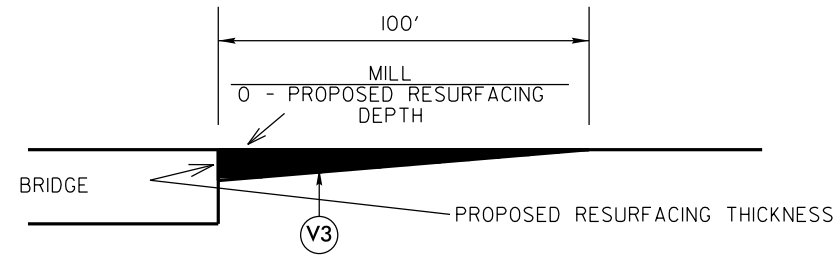

MILLING DETAIL AT BRIDGE APPROACHES

WHERE BRIDGES WILL NOT BE RESURFACED. THIS WILL BE PAID FOR AS INCIDENTAL MILLING. USE AT BRIDGE NUMBER: 16

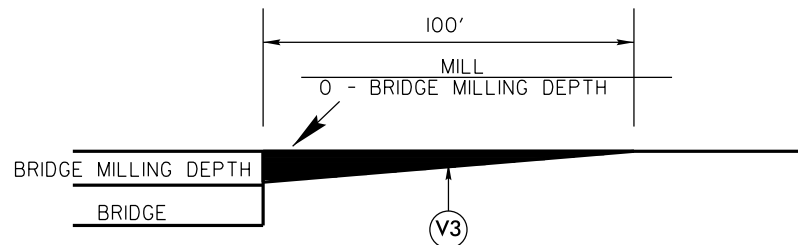

MILLING DETAIL AT BRIDGE APPROACHES

WHERE BRIDGES WILL BE MILLED THEN RESURFACED. THIS WILL BE PAID FOR AS 2" MILLING. USE AT BRIDGE NUMBER: 33

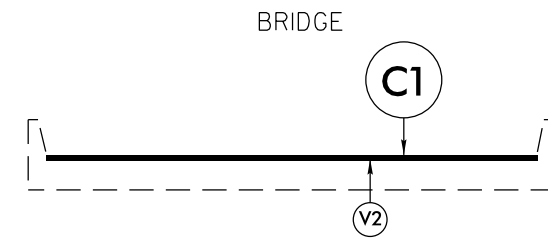

BRIDGE DETAIL

**BRIDGE NUMBER 33
MILL 2" OFF EXISTING PAVEMENT**

*NOT TO SCALE
STATIONS ARE FIELD MEASURED ALONG
EXISTING CENTERLINE

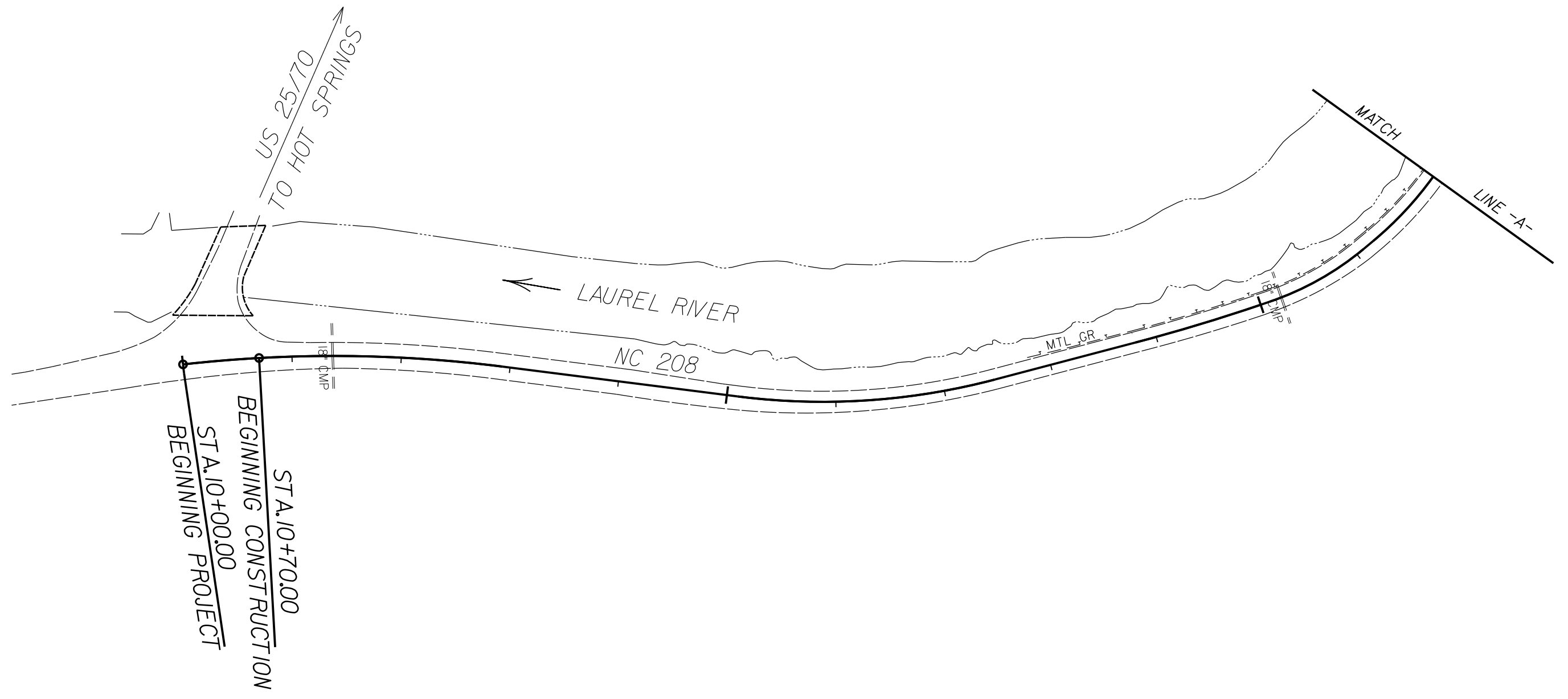
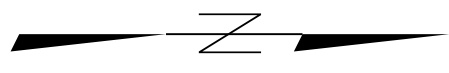

*NOT TO SCALE
STATIONS ARE FIELD MEASURED ALONG
EXISTING CENTERLINE

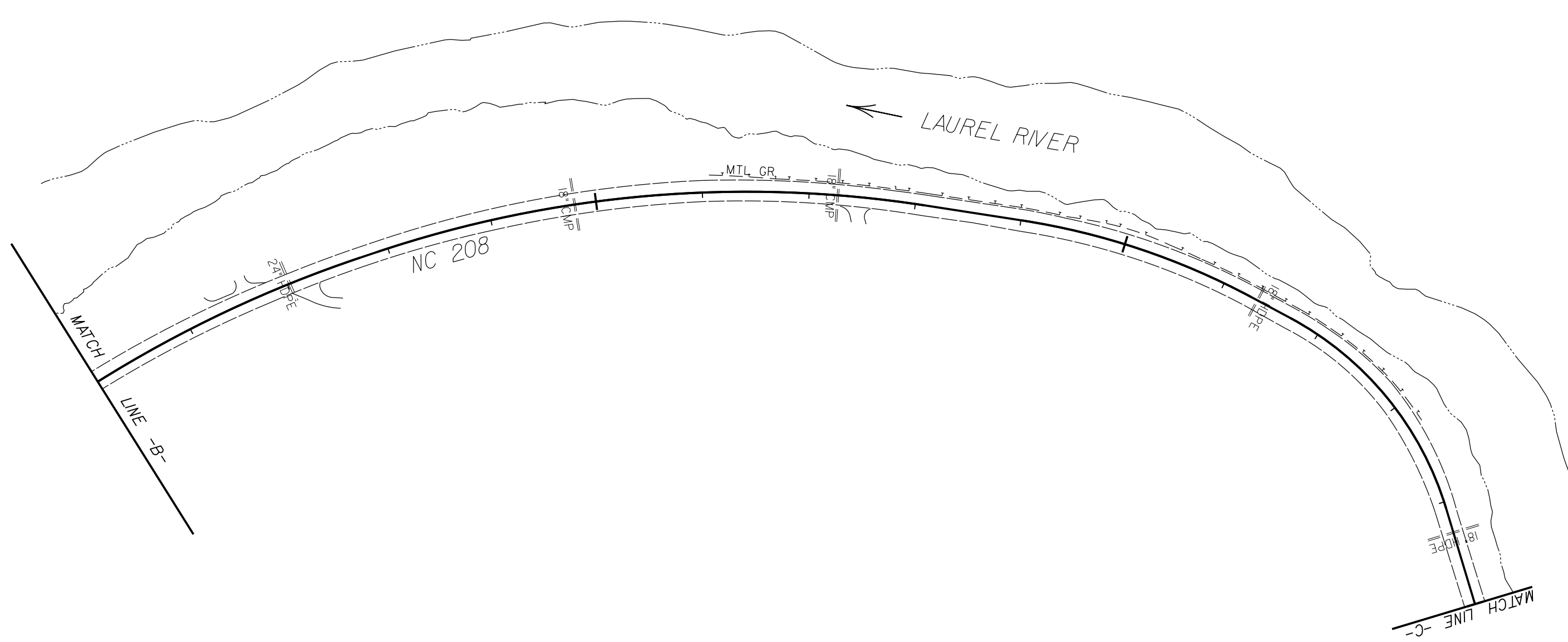

*NOT TO SCALE
STATIONS ARE FIELD MEASURED ALONG
EXISTING CENTERLINE

